

Nikon

35mm Film Scanner

LS-1000

User's Manual

Contents

1. Overview
 - 1.1 Features
 - 1.2 Operating Environment
2. Before Operation
 - 2.1 Inspection
 - 2.2 Accessories
 - 2.3 Options
 - 2.4 Notes on Use
 - 2.5  Cleaning the Unit
3. Parts Identification
 - 3.1 Main Unit
 - 3.2 Display LED
 - 3.3 Strip Film Holder FH-2
4. Connecting the LS-1000
 - 4.1 Before Connection
 - 4.2 Connecting the Power Cord
 - 4.3 Connecting the SCSI Cable
 - 4.4 Setting the SCSI ID
5. Operation
 - 5.1 Turning on the Power
 - 5.2 Film Insertion
6. Troubleshooting
- Appendix: Specifications
- Index



Cautions

- The reproduction of all or part of this manual without our permission is prohibited.
- The information contained in this manual is subject to change without notice.
- We have made every effort to produce a perfect manual, but should you find any mistakes, we would be grateful if you would kindly let us know.
- We shall take no responsibility for consequences resulting from the operation of this product, despite the terms mentioned above.

Trademark Information

Macintosh is a registered trademark of Apple Computer, Inc.

Microsoft is a registered trademark and Windows is a trademark of Microsoft Corporation.

IBM PC/AT is a trademark of International Business Machines Corporation.

Other brand or product names are the trademarks or registered trademarks of their respective holders.



Indication

The  indications in this manual signify important safety precautions. In order to use this product safely, please read every section where these indications are placed before beginning operation, this product. These indications are also placed in the table of contents so users can find them easily.



Indication

The  indications in this manual signify the need for caution when using the products. These indications are placed in sections that should be read by users before beginning operation, in order to avoid damage to the product.

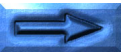

Federal Communications Commission (FCC) Radio Frequency Interference Statement

This equipment has been tested and found to comply with the limits for a Class B digital device, pursuant to Part 15 of the FCC Rules. These limits are designed to provide reasonable protection against harmful interference in a residential installation. This equipment generates, uses, and can radiate radio frequency energy and, if not installed and used in accordance with the instructions, may cause harmful interference to radio communications. However, there is no guarantee that interference will not occur in a particular installation. If this equipment does cause harmful interference to radio or television reception, which can be determined by turning the equipment off and on, the user is encouraged to try to correct the interference by one or more of the following measures:

- Reorient or relocate the receiving antenna.
- Increase the separation between the equipment and receiver.
- Connect the equipment into an outlet on a circuit different from that to which the receiver is connected.
- Consult the dealer or an experienced radio/TV technician for help.

CAUTIONS

Modifications

The FCC requires the user to be notified that any changes or modifications made to this device that are not expressly approved by Nikon Corporation may void the user's authority to operate the equipment.

SCSI Cable

Please use the SCSI cable listed on page 5 in the user's Manual supplied with the scanner. Using other interface cables may exceed the limits of the class B Part 15 of FCC rules.

Notice for customers in Canada

CAUTION

This class B digital apparatus meets all requirements of the Canadian interference Causing Equipment Regulations.

ATTENTION

Cet appareil numérique de la classe B respecte toutes les exigences du Règlement sur le matériel brouilleur du Canada.

Notice for customers in European countries

ACHTUNG

Dieses Gerät entspricht den Bestimmungen der EG-Direktive 87/308/EEC zur Störungsunterdrückung. Lärmemission kleiner 70 dBA



Cautions for Safety

In order to use the LS-1000 safely and correctly, and to prevent problems, pay careful attention to the following points:

- Use an AC power supply of 50/60Hz and a voltage of from 100V–240V. Be sure to use a power cord rated for the appropriate voltage.

At voltages of more than AC 125V:

use a power cord that complies with the safety standards of the country in which it is used, which has a plug rated for AC 250V, 15A (NEMA 6P-15) and insulation of SVT type or better, and which is more than AWG18 in thickness.

At voltages of AC 125V or less:

use a power cord that complies with the safety standards of the country in which it is used, which has a plug rated for AC 125V, 10A and insulation of SVT type or better, and which is more than AWG18 in thickness.

- Be sure that the electrical outlet of the power supply is grounded. Conduct the grounding in common to the other machines it is being connected with. Unless common grounding is conducted, ground loop will occur, which will cause electric shock and noise static.

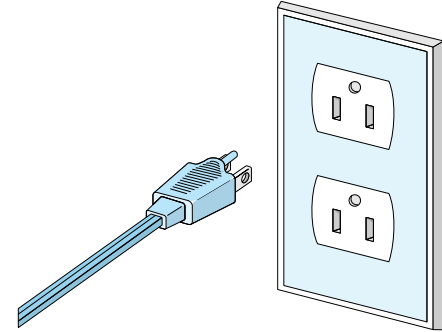

- Do not conduct the grounding to a gas pipe or a water pipe.
- When plugging in or unplugging the power cord, be sure to touch only the plug.

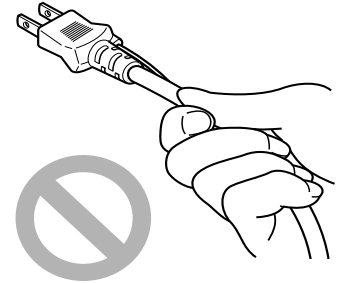
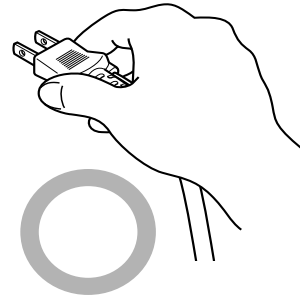

- Do not pull or bent the SCSI cable. This can cause the cable to break.

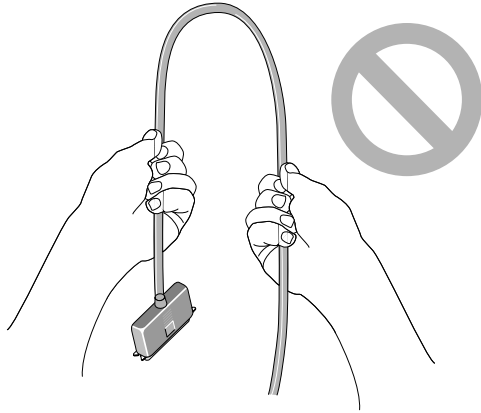

- Do not connect or remove peripheral equipment while the power switch is on.
- Do not unplug the power cord while the power switch is on.
- Do not move the Unit while the power switch is on.
- Once the power switch has been turned off, wait at least five seconds before turning the power switch on.

- On no account disassemble the Unit. The high voltage parts inside the unit can cause electric shock.

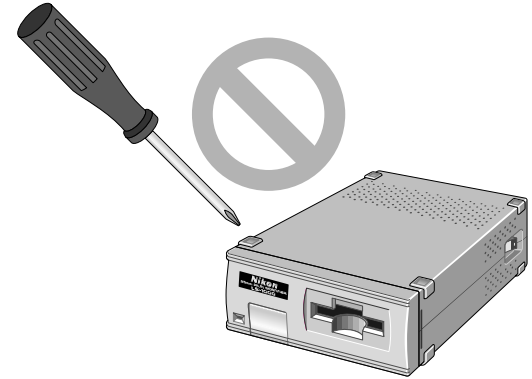

- Do not insert any foreign objects inside the unit. If flammable objects, metal, or water come in contact with the interior of the unit, failure, fire, and/or an electrical shock may result.
- Avoid harsh substances such as alcohol, benzene, thinner, or pesticides, as failure, fire, and/or an electrical shock may result.
- Do not subject the unit to any strong shocks. This can cause breakage and failure.
- Do not place heavy objects on the unit.

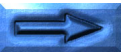

If You Notice Anything Abnormal

If unusual noise, odor or smoke occurs, switch the Unit off immediately and disconnect the power cord and the SCSI cable. Contact your retailer or Nikon sales representative in your country.

Storage and Operating Locations

Proper storage will ensure the long life of the Unit. In order to avoid internal dust while being stored, it is recommended that an appropriate cover be used on the Unit.

Do not store or use where:

- The temperature is above 95°F (35°C) or below 50°F (10°C), the temperature changes drastically, or condensation occurs.

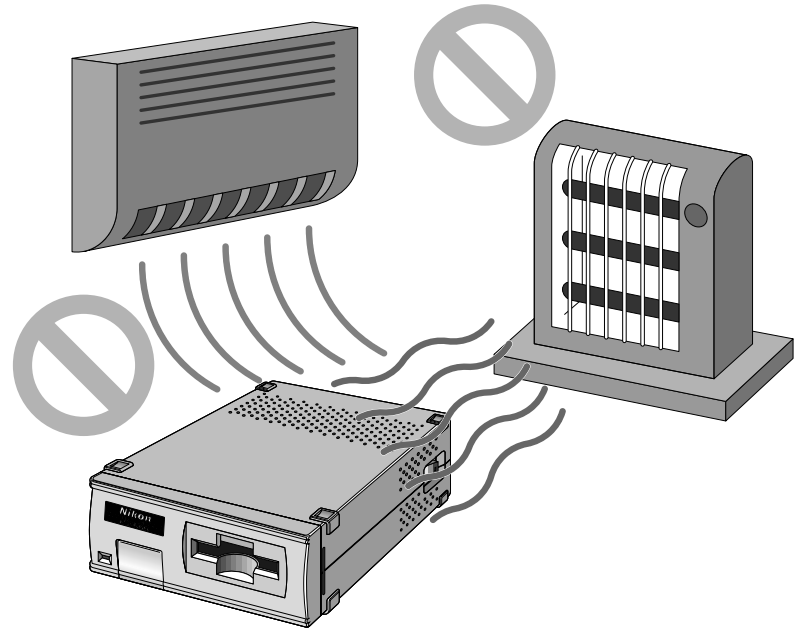

- The humidity exceeds 80%.



- The Unit is exposed to direct sunlight.

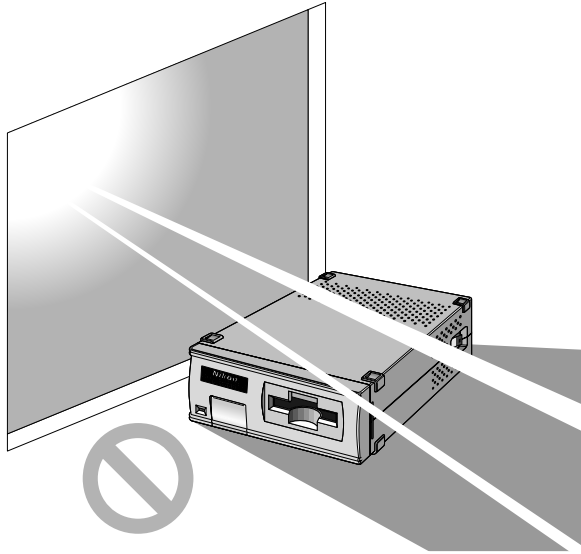

- The atmosphere is excessively dusty.

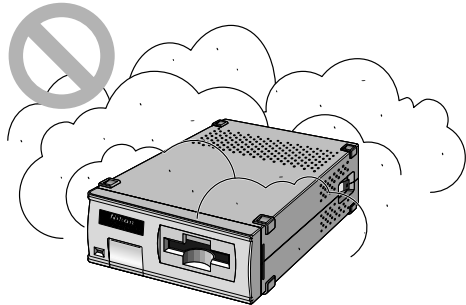

- The Unit may be subjected to excessive vibration or physical shocks.

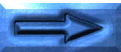
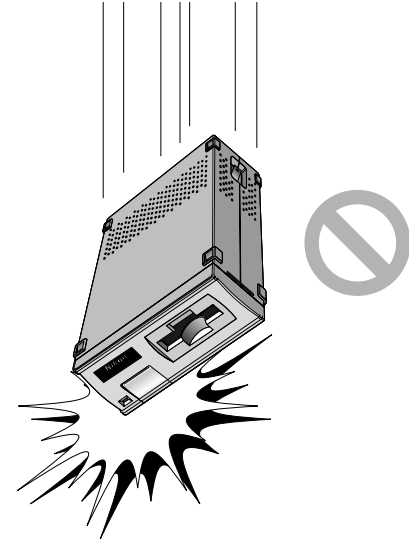

- The Unit is exposed to noise from other equipment nearby.

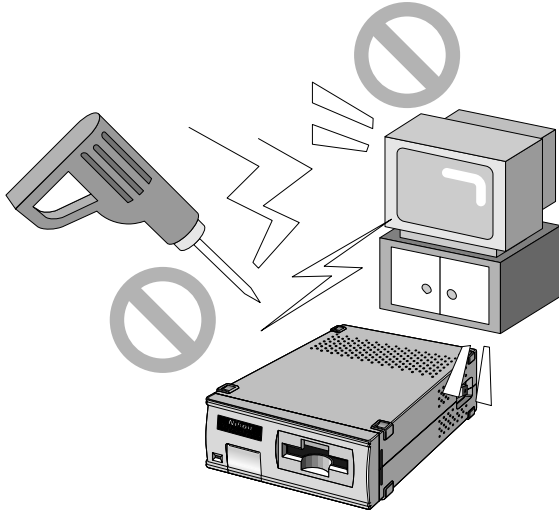

Leave sufficient space around the Unit to ensure that the ventilation slots are not blocked. Blocking these slots may cause an internal heat build-up.

Place the unit on a level and stable surface for operation. If operated in any other way, problems will occur.

Transportation Precautions

When transporting the Unit, pack the unit with the original package box and packing material provided by Nikon.

When Taking the Unit Out of The Country

The use of this product may violate local laws and restrictions in some countries. If this is the case, we cannot bear any responsibility for any violations resulting from the use of this product.

Notice concerning prohibition of copying or reproduction

Note that simply being in possession of material which has been copied or reproduced by means of a scanner may be punishable by law.

- **Items prohibited by law from being copied or reproduced**

Do not copy or reproduce paper money, coins, securities, government bonds, or local government bonds, even if such copies or reproductions are stamped "Sample".

The copying or reproduction of paper money, coins, or securities which are circulated in a foreign country is prohibited.

The copying or reproduction of unused postage stamps or post cards issued by the government without obtaining approval from the government is prohibited.

The copying or reproduction of stamps issued by the government and certified documents stipulated by law is prohibited.

- **Cautions on certain copies and reproductions**

The government has issued cautions on copies or reproductions of securities issued by private companies (shares, bills, checks, gift certificates, etc.), commuter passes, or coupon tickets, except when a minimum of necessary copies are to be provided for business use by a company. Also, do not copy or reproduce passports issued by the government, licenses issued by public agencies and private groups, ID cards, and tickets, such as passes and meal coupons.

- **Comply with copyright notices**

The copying or reproduction of works such as books, music, paintings, woodcut prints, maps, drawings, movies, and photographs which are copyrighted creative works is prohibited except when it is done for personal use at home or for similar restricted and non-commercial use.



I. Overview

Thank you for purchasing the Nikon 35mm Film Scanner LS-1000. This manual describes the procedures for unpacking, setting up, and connecting the scanner, with emphasis on hardware use and cautions.

Please read this manual thoroughly to ensure proper operation of your scanner.

For an explanation of how to scan and reproduce images with the LS-1000, please refer to the [software manuals](#).

We hope that you will find this manual helpful.

I.1 Features

The LS-1000 is a film scanner capable of scanning 35mm film (color/monochrome, negative/positive) at high speed and high resolution.

- 3-color, high-brightness LED illuminant, eliminating the need for illuminant maintenance
- High-speed single-pass scanning capability
- High quality images produced by using a 12-bit A/D converter
- Maximum pixel count of 2,592 × 3,888 and high resolution of 2,700dpi
- Auto-focus function, eliminating the need for manual focusing
- Compact, lightweight design, with low power consumption
- Consecutive automatic scanning capability with the optional auto slide feeder

I.2 Operating Environment

Leave extra space around and above the unit to ensure smooth operation. Please refer to the drawing below for the amount of space to be provided.

If possible, place a suitable cover over the unit to avoid dust accumulating when it is stored.

In the case of vertical installation

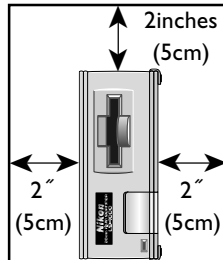
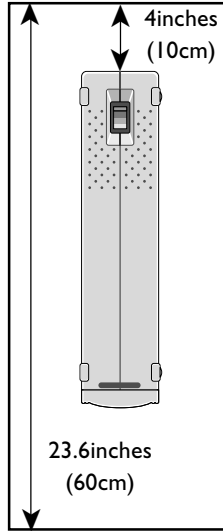

In the case of horizontal installation

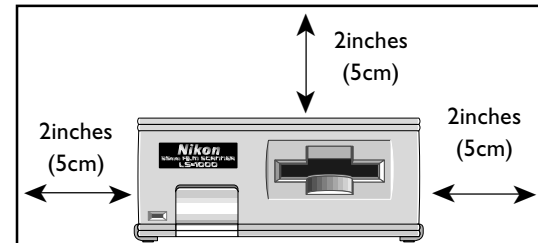
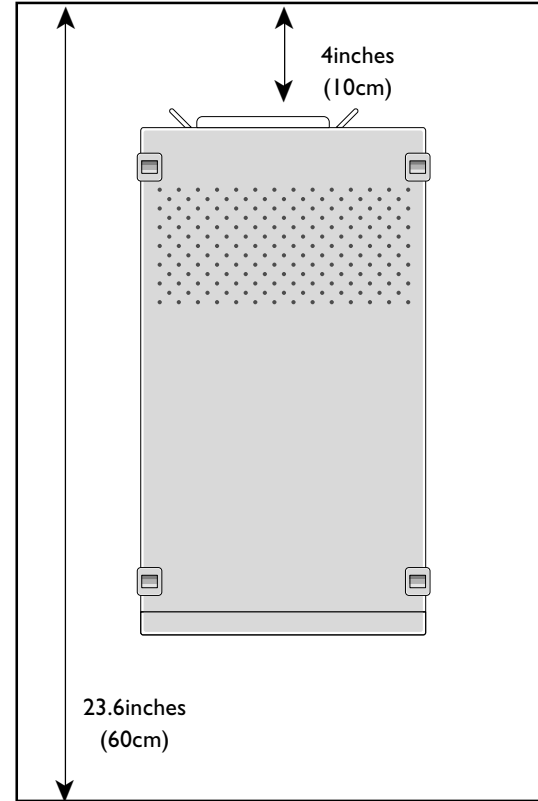

2. Before Operation

2.1 Inspection

Inspect the package to see whether any damage has occurred during shipment. If there is any damage to the package, please contact our retailer directly and do not unpack the unit.

2.2 Accessories

The following items are included with your LS-1000. When you open the package, check whether all the items are present. If there are any missing items, please contact your retailer immediately.

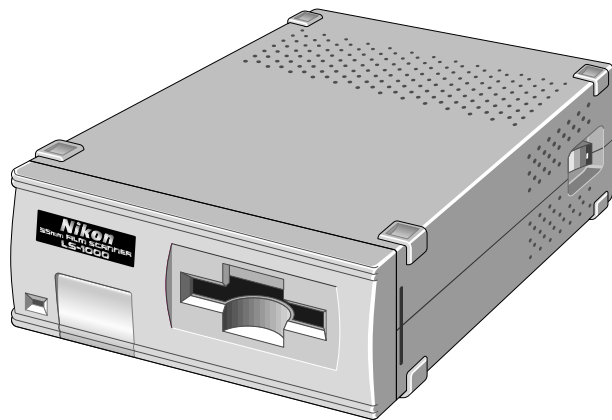

LS-1000 Main Body (1)



Power cord (1)

* The shape of the plug depends on the country of use.

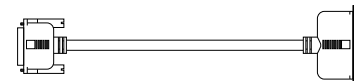

SCSI cable (1)
(50pin full pitch Dsub 25pin)



FH-2 Strip Film Holder (1)

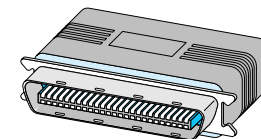

Terminator (1)



LS-1000 user's manual(s)
Software disk(s)

2.3 Options

The LS-1000 has an optional auto slide feeder, the **SF-100**, which enables automatic feeding of mounted 35mm slides.

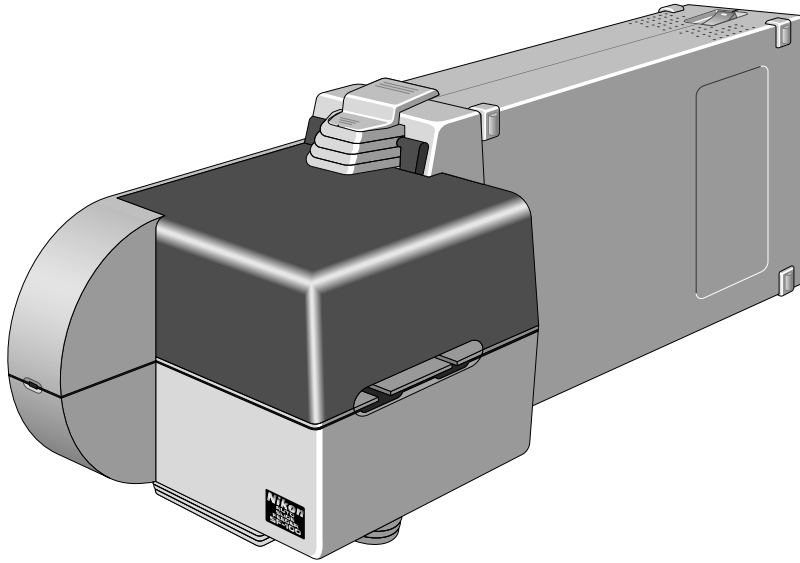

2.4 ✓ Notes on Use

- *Don't use a slide mount neither less than 1.1mm nor more than 3.0mm thick. If the slide mount is not flat on its surface, you may feel some roughness when mounting or unmounting the slide.*
- *Don't force the slide-mount or strip film holder into or out of the unit if it does not move smoothly.*
- *When scanning a film, don't touch or unmount the slide-mount or strip film holder.*
- *Keep the unit in a horizontal position.*

2.5 Cleaning the Unit

When carrying out routine maintenance and cleaning, ensure that no volatile liquids such as alcohol, benzene, or thinner come into contact with the LS-1000 as this may cause a failure, fire, or electric shock.

Please observe the following points:

- Before cleaning, always turn the power off, and pull out the power plug.
- Since the front cover is made from plastic material, remove dust with a blower or a dry cloth.

Use a soft, dry cloth to remove dust from the metal panel at the rear.

- If the unit has become badly soiled, clean with a cloth moistened with a neutral liquid detergent, then dry with a dry cloth.

Avoid harsh substances such as alcohol, benzene, thinner, or pesticides, as they may damage the surface, or remove the exterior finish.

3. Parts Identification

3.1 Main Unit

Front panel

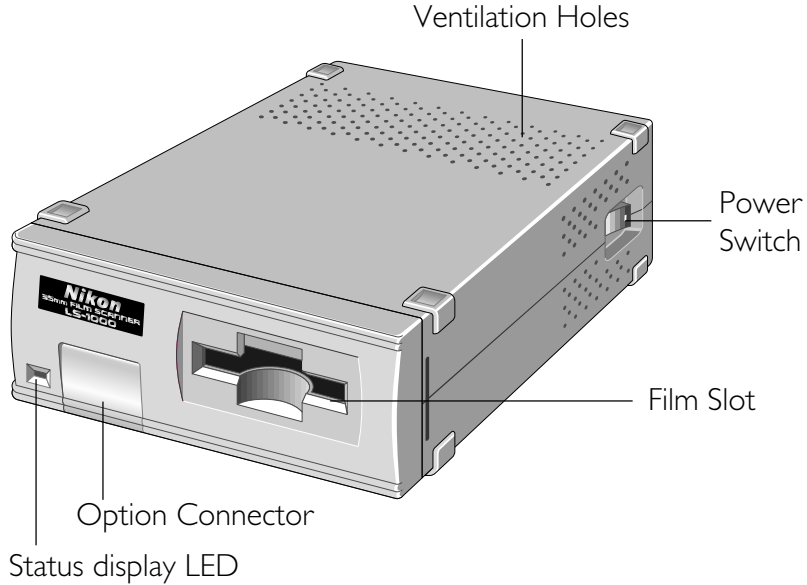

Film Loading Slot:

The film holder is inserted here.

Option Connector:

The SF-100 slide autofeeder is connected to this option connector.

Status Display LED:

Shows the scanner status.

Power Switch:

Directly turns the AC power on/off.

Ventilation Holes:



Since air is drawn in through these holes, make sure that they are not blocked by other equipment.



Rear panel

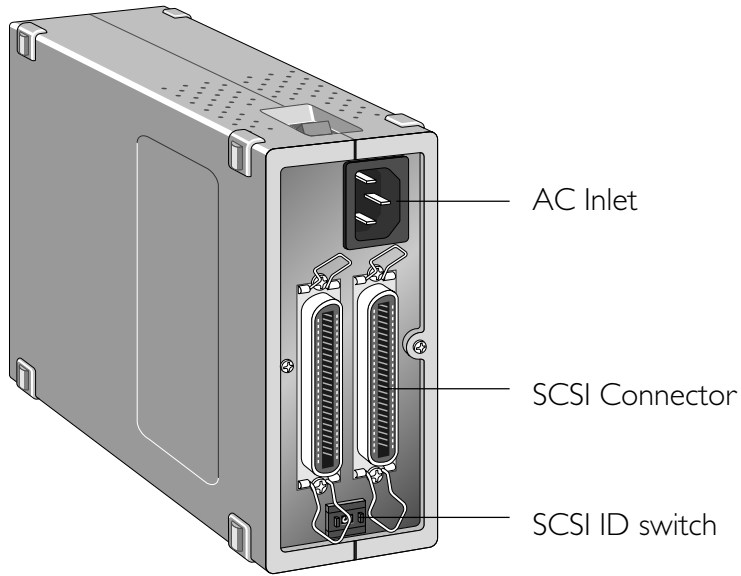

SCSI Connector:

For SCSI cable connection. (No difference between IN and OUT.)

SCSI ID Switch: Sets the SCSI ID number. Numbers 0 to 7 are shown and valid.

AC Inlet:

Connect to the AC power source with the power cord provided.

3.2 Display LED

The display LED is located on the front panel and shows the scanner status.

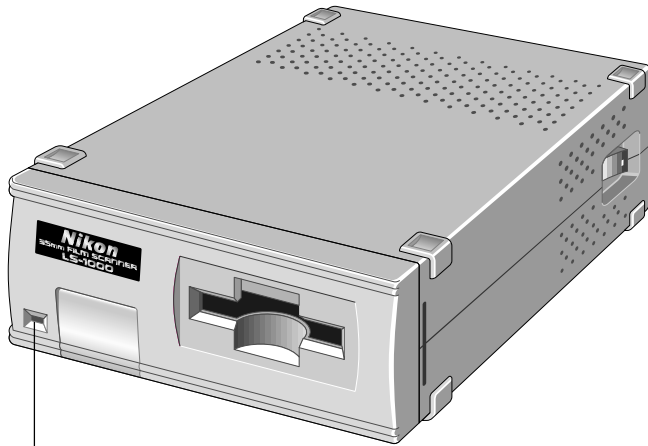

Status display LED

Steady illumination:

Lights when power is supplied (READY status).

Blinking (about once every 1.5 seconds):

Blinks slowly during operation (BUSY status). Also blinks when the power is switched on and during initialization.

Fast blinking (about 5 times a second):

Blinks fast when an error occurs either in the LS-1000 or in communication (ERROR status).

Note: *The blinking cycle may sometimes be irregular, but this does not necessarily signify a product malfunction.*

3.3 Strip Film Holder FH-2

This strip film holder can be used with a strip of film containing up to six images.

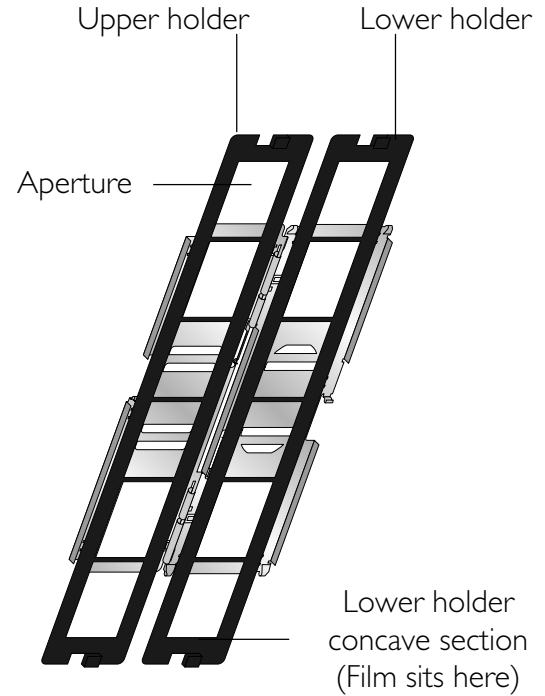
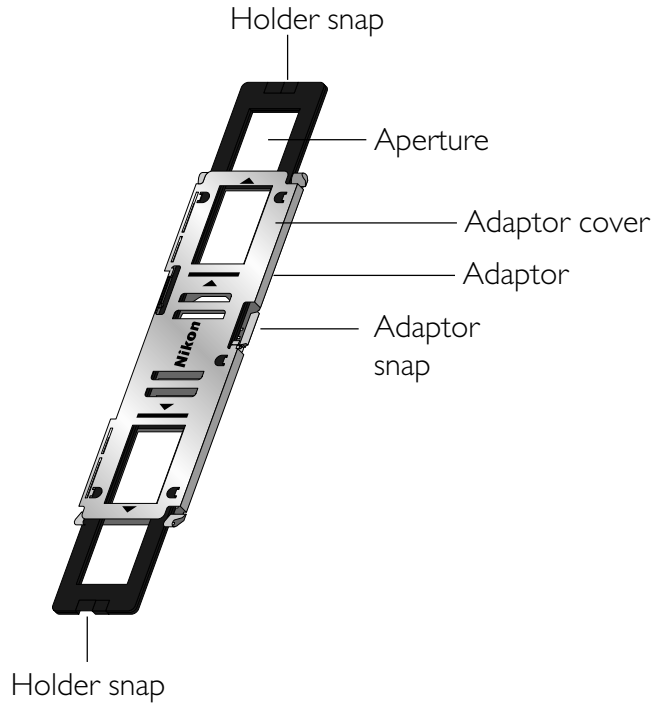

4. Connecting the LS-1000

4.1 ✓ Before Connection

Before connecting the cables, confirm that all devices, including the computer system and the LS-1000, are turned off.

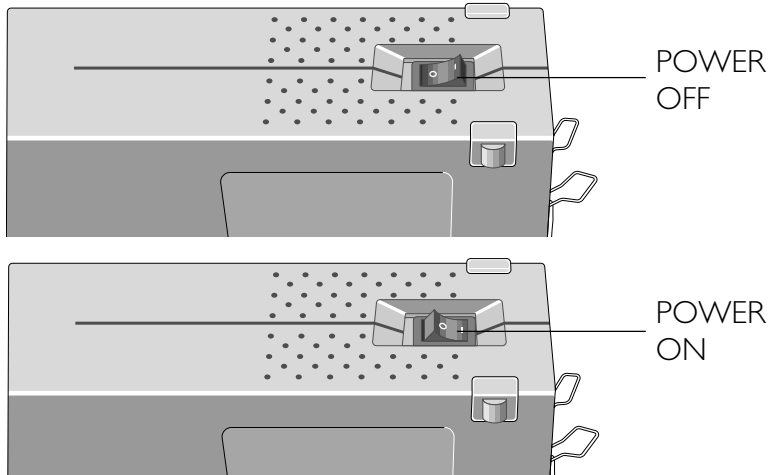

For an IBM PC/AT or compatible in which an SCSI board has not been installed, install an SCSI board as explained in the manual supplied with the board.

When installing an SCSI board for the first time, be careful not to use the same number as used for another purpose such as an I/O address, interrupt number, or graphic board DMA channel.

Note: Make sure that the PC is powered off before installing the SCSI board.

4.2 Connecting the Power Cord

Before connecting the power cord, confirm that the unit's power switch is in the off position.

Insert the female end of the supplied power cord into the AC inlet located on the rear panel, then insert the plug into the AC power outlet.

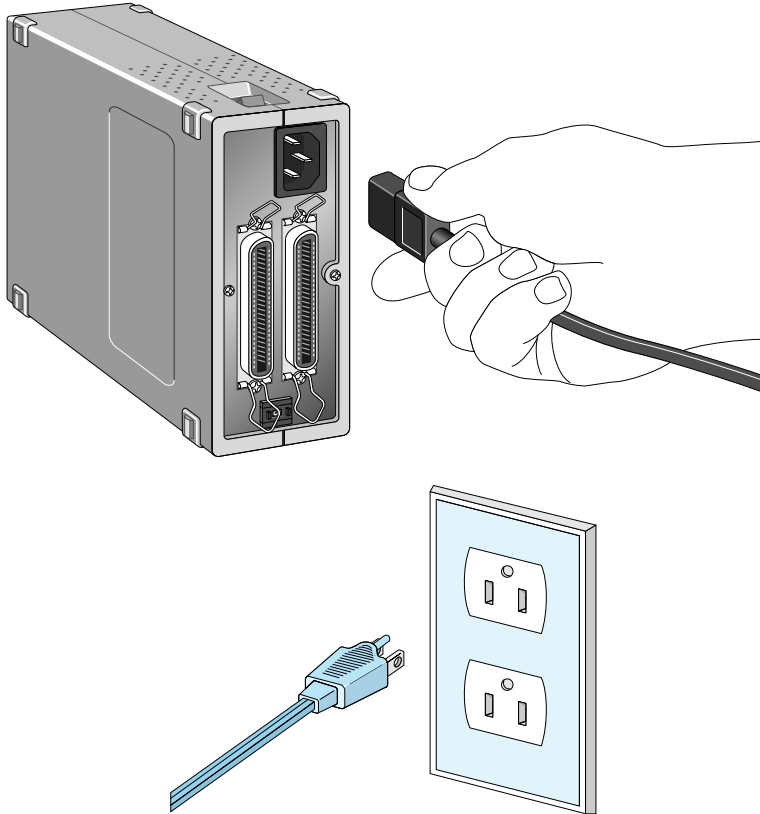

* The shape of the plug depends on the country of use.

-  *The power source must be grounded.*
- *If possible, try to use an independent electric outlet. If the unit is connected to an outlet to which an electric household appliance, such as a vacuum cleaner or air-conditioner, is connected, the product may experience power source noise interference.*
- *Do not extend the power cord of the product, as this may cause malfunction.*

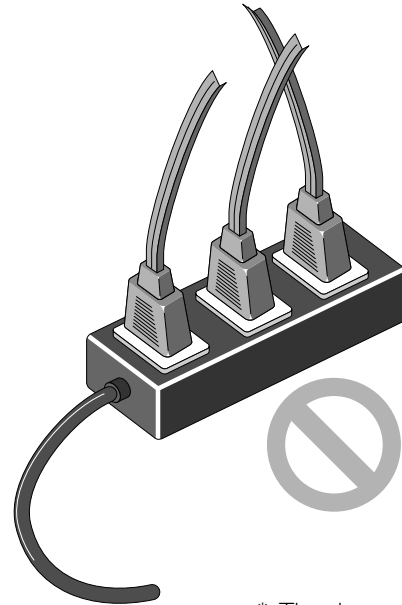

* The shape of the plug depends on the country of use.

4.3 Connecting the SCSI Cable

Before connecting the SCSI cable, confirm that all SCSI devices, including the computer system, have been turned off.

Connect the unit to the computer using the SCSI cable. After attaching the connector, be sure to lock it in place. You can connect the SCSI cable to either of the SCSI connectors on the rear panel of the unit.

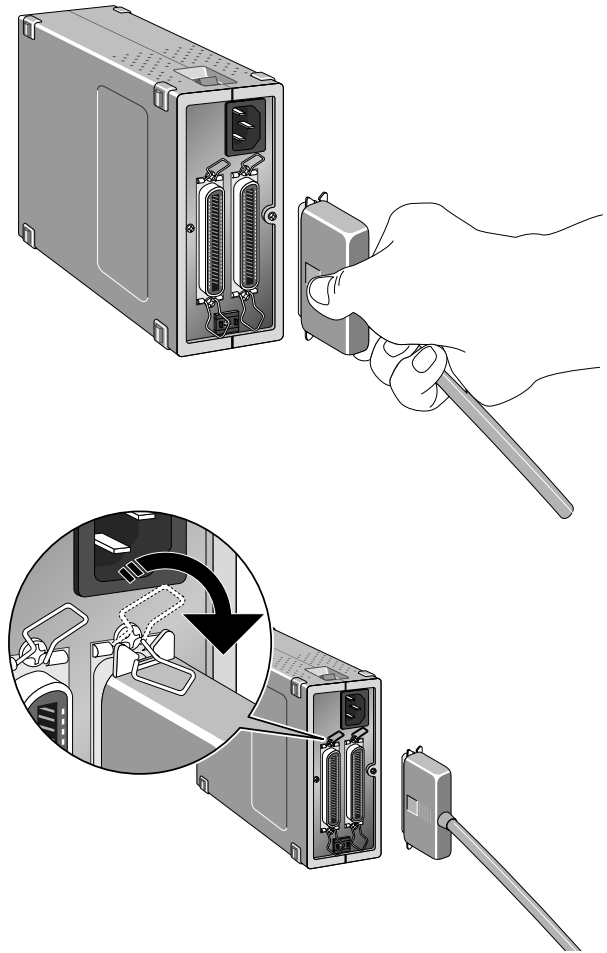

If the unit is the only connected SCSI device, or if the unit is connected at the end of the SCSI chain, attach a terminator (terminal resistance) to the other SCSI connector. At this point, remove the terminator of the other SCSI device that has been placed between them. The terminator is not needed when the unit is connected between other SCSI devices.

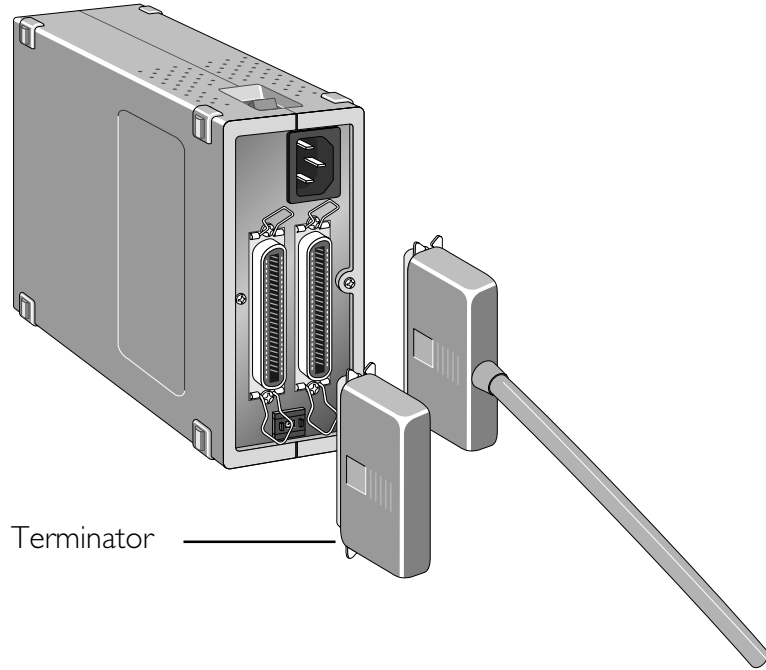

When SCSI devices are connected, connect them so as not to make a loop, and attach terminators to both ends of the SCSI chain. Since the terminator is built into the host computer in most cases, the host computer should be at the end of the SCSI chain. The operation manuals of some notebook computers require a terminator to be attached outside the computer; please refer to the operation manual for the computer to which the unit is connected.

Note: *The SCSI cable used for SCSI connection should be of high-impedance type.*

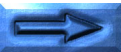

SCSI Chain Connection with Other Devices

If the LS-1000 is connected at the end of the SCSI chain;

- Connect the 50-pin full pitch connector of the SCSI cable to the SCSI connector located on the rear panel of the Unit, and insert the other end to the SCSI connector of other SCSI device.
- Connect the supplied terminator (terminal resistance) to the other SCSI connector on the rear panel of the Unit.

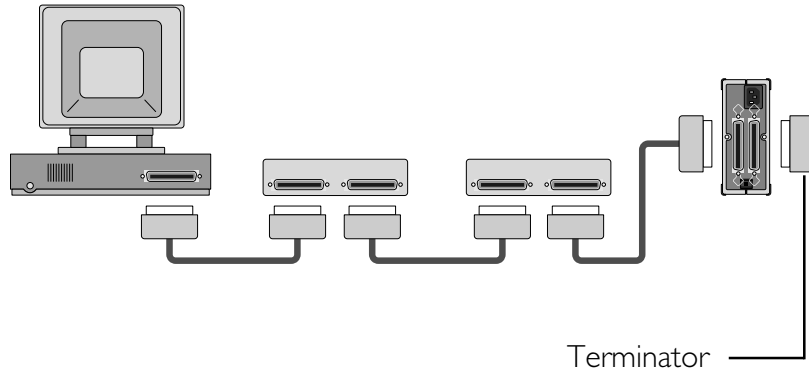

If LS-1000 is connected between the other SCSI devices;

- Connect the 50-pin full pitch connector of the SCSI cable to the SCSI connector located on the rear of the Unit, and insert the other end to the SCSI connector of other SCSI device.
- Connect the other SCSI device by using the other SCSI connector on the rear panel of the Unit.
- Connect the supplied terminator (terminal resistance) to the SCSI device connected at the end of SCSI chain.

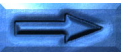
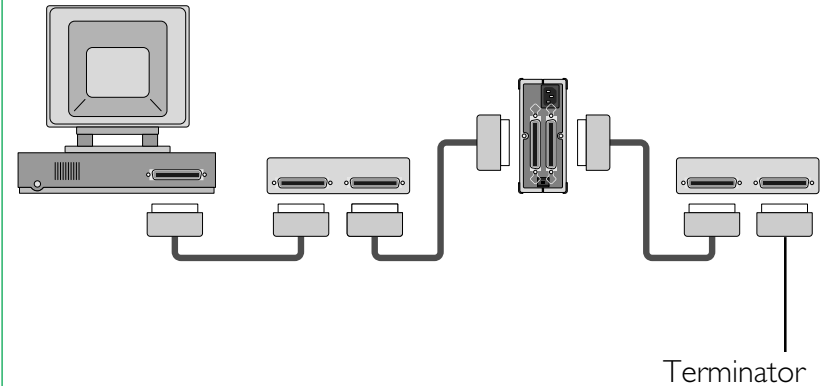

Remarks

- The maximum number of SCSI devices that can be connected to one computer is eight. In the case of a host computer with a built-in SCSI hard disk or built-in CD-ROM, note that SCSI ID numbers have been pre-assigned for the host CPU and the SCSI devices.
- The SCSI cable must not be extended beyond a total length of 19 feet (6 meters), or else failure may result.
- If you use the type of terminator that is inserted between the SCSI cable and SCSI interface connector, install a terminator independent of the other SCSI connector of the LS-1000.
- Terminators must be attached to the devices located at both ends of the SCSI chain.

If the host computer is a Macintosh, the Macintosh itself will provide termination at one end of the chain.

If the host computer is an IBM PC/AT or compatible, equipped with an SCSI board, the SCSI board itself will present termination at one end of the chain.

Note that when an SCSI chain connection is made inside a computer, the end of the SCSI device inside the computer will become the end terminal.

- Before installing an SCSI board, be sure to read the user's manual provided with the board. The numbers for the I/O address, interrupt level (INT) and DMA channel might be used for other interface boards and peripheral devices. If so, change them as explained in the manual.

4.4 Setting the SCSI ID

The SCSI ID for the LS-1000 is set at “5” when the unit is shipped. If other SCSI devices are connected to your computer, make sure that the SCSI ID for the LS-1000 is different from those assigned to other SCSI devices.

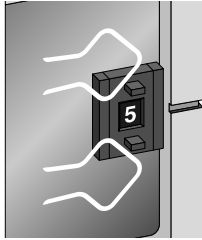

Note that in the case of a host computer which has a built-in SCSI hard disk or built-in CD-ROM, the ID numbers of the host CPU and each SCSI device have already been assigned.

If the IDs are the same, you must change the ID number of the other SCSI device or the ID of the LS-1000 to avoid any conflict.

✓ Remarks

- To change the ID, confirm that the LS-1000 power is off. The ID cannot be changed when the power is on.
- As 7 has been assigned for the CPU and 0 has been assigned to the built-in hard disk for a Macintosh, and 0 and 7 have also been assigned to other personal computer systems, any number from 1 to 6 is recommended for the ID number.
- If the same ID numbers are assigned, the system might not function, or important data on the hard disk might be destroyed. It is therefore essential to check the ID numbers carefully before connecting the LS-1000.

5. Operation

5.1 Turning on the Power

Turn the LS-1000 on first, the other SCSI devices next, and the host computer last.

After turning the power on, the LED will begin to blink to indicate scanner initialization.

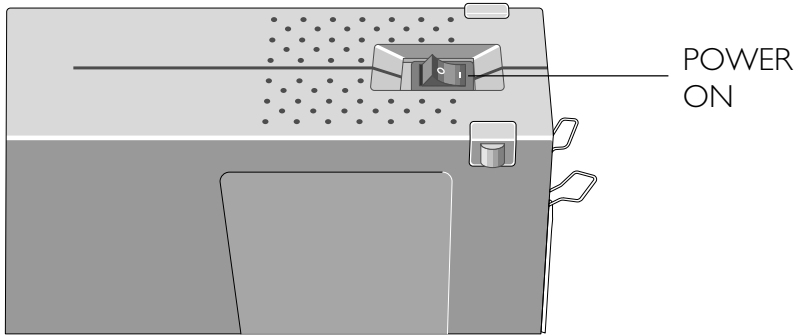

✓ Remarks

- To turn the LS-1000 power off, turn the host computer off first, the other SCSI devices next, and the LS-1000 last (reverse order from switching on).
- Once the power is turned off, please wait five seconds or more before turning the power on again.
- Do not turn the power on/off while the scanner is scanning.

5.2 Film Insertion

The LS-1000 can scan different types of 35mm positive/negative monochrome/color images. In addition, it can scan a film strip of up to 6 images or single mounted film.

Insertion of Mounted slides

The LS-1000 can scan mounted slides as they are.

- Confirm that the thickness of the mounted slides to be scanned is between 1.1mm and 3.0mm.
- Ensure that the emulsion surface is facing in the proper direction.

When the LS-1000 is installed vertically, insert the mounted slide so that the emulsion surface is facing toward the right (shiny surface facing left).

When the LS-1000 is installed horizontally, insert the mounted slide so that the emulsion surface is facing downward (shiny surface facing upward).

- * All film has an emulsion surface and a base surface. The emulsion surface is slightly convex and concave. The base surface is neither concave nor convex and is shinier than the emulsion surface.

Insert the mounted slide lengthways until it touches the back inner wall.

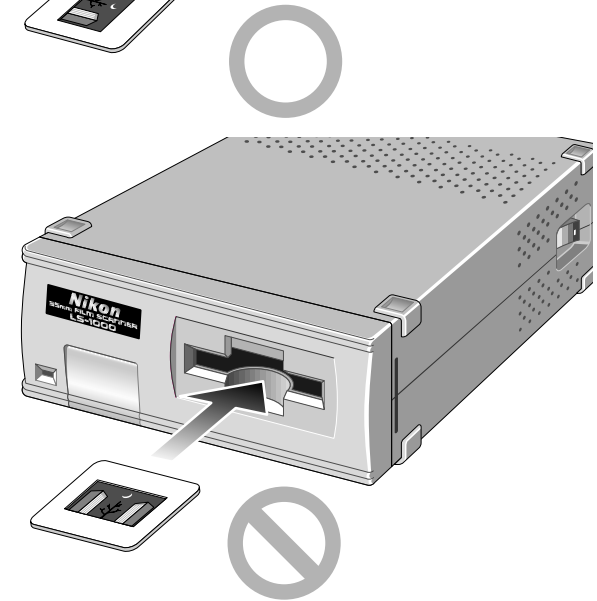
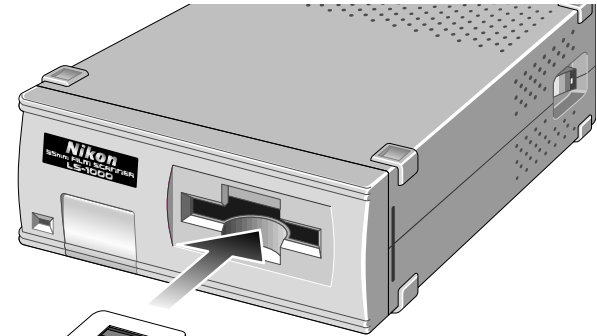

Note: Do not insert the mounted slide so that the width and length of the mount are reversed. If you do so, the LS-1000 will not be able to scan both sides of the mounted slide.



The standard orientation of a mounted portrait or landscape slide is shown below. (If the top and bottom are reversed, modification is possible by using the software.)

Orientation of a portrait slide

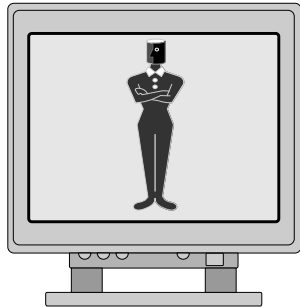
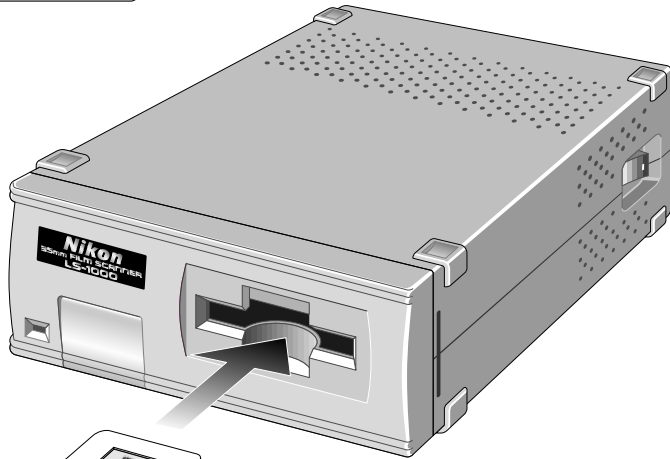
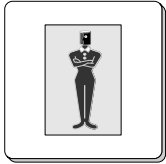

Orientation of a landscape slide

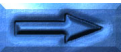
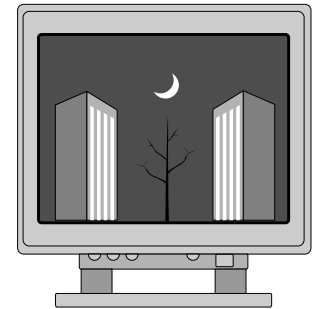
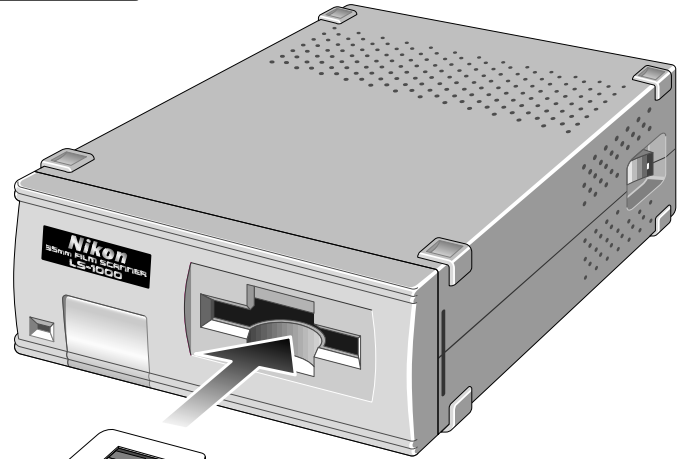
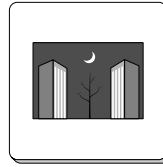

Insertion of Strip film

Insert the strip film into the attached film holder FH-2, and then insert the holder into the film slot of the front panel of the Unit.

Step 1

Remove the adaptor snap and open the upper holder. Be sure the word Nikon, printed on the adaptor cover of the upper holder is facing upward.

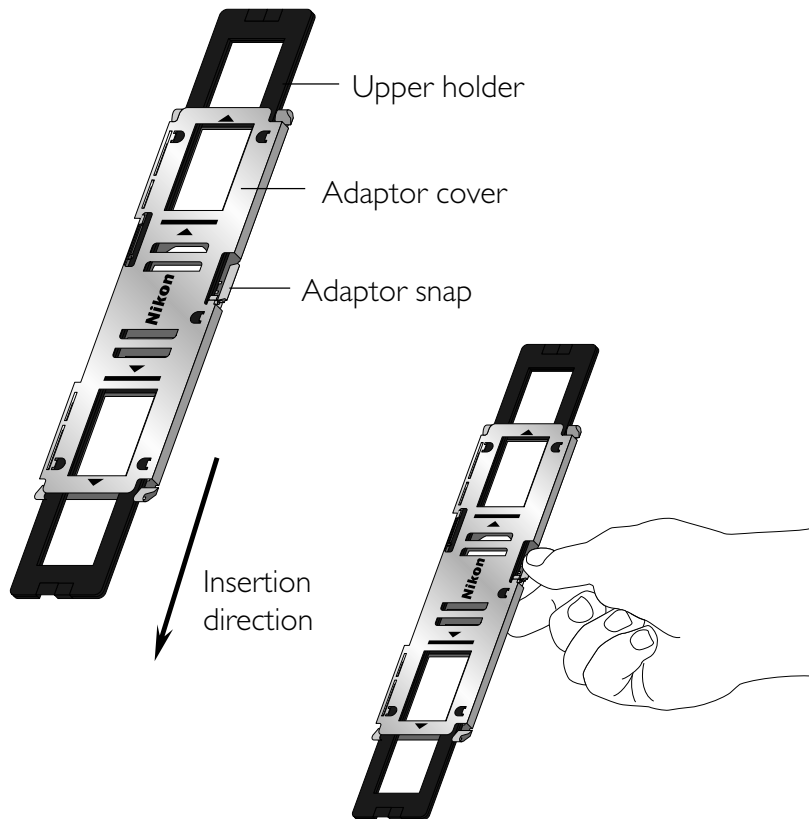

Step 2

Place the strip film on the concave section which is fixed in the adaptor of the lower holder. Be sure to place the strip film so that the emulsion surface will be facing down (the shiny surface will be facing up). The direction is correct if the image number can be read.

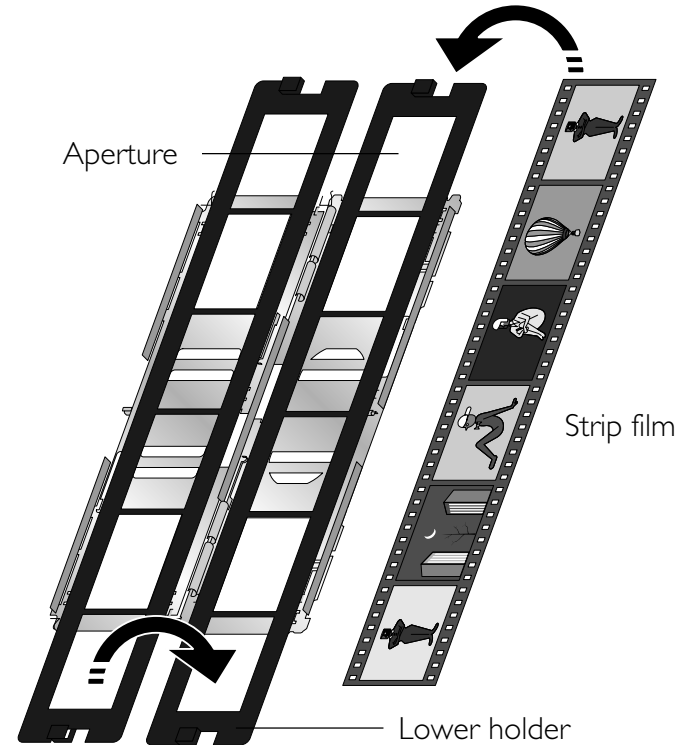

Step 3

Align each image of the strip film with an aperture in the lower holder.



Step 4

Close the upper holder, aligning both ends of the upper holder and the lower holder.

Fasten the snaps at both ends of the holder after securing the adaptor cover and fastening the adaptor's snap.

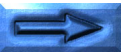
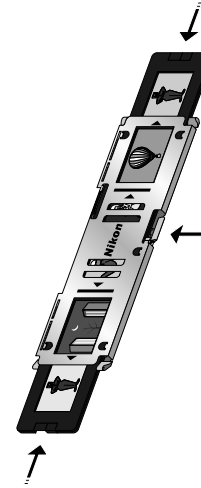

Step 5

Align the image to be read with either of the two apertures in the silver-colored adaptor.

Insert the film holder in the film slot of the front panel in the LS-1000, with placing the aperture through which the image is to be read toward the slot.

The film holder can be inserted into the LS-1000 from either end. Decide the insertion direction of the film holder according to which image is to be read.

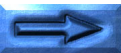
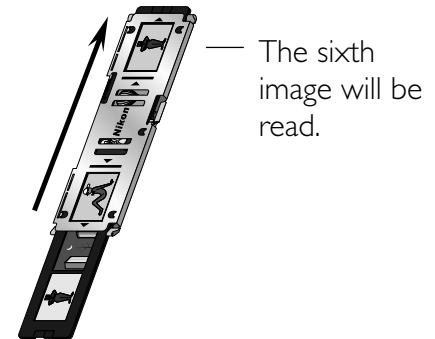
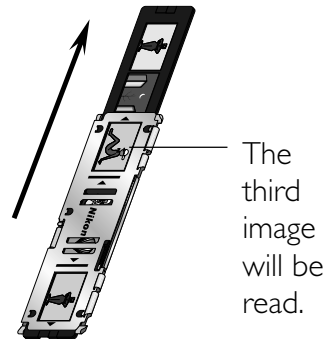
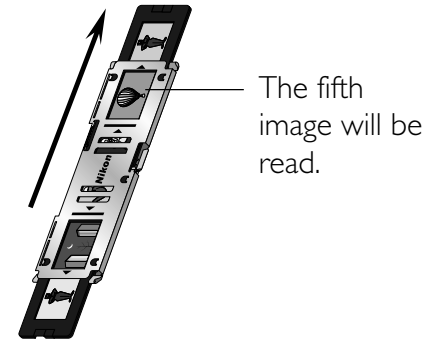
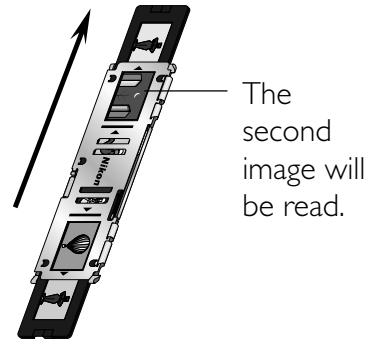
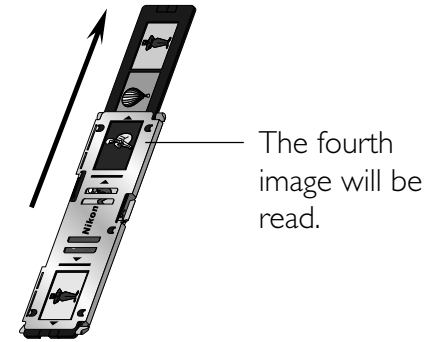
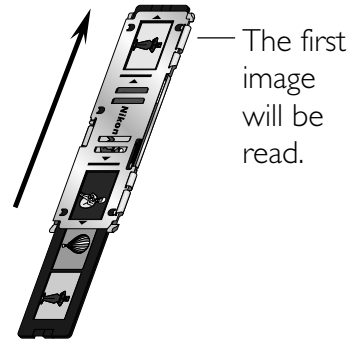

Step 6

Insert the film holder until it touches the back inside wall of the unit and the mark comes in alignment with the edge of film slot.

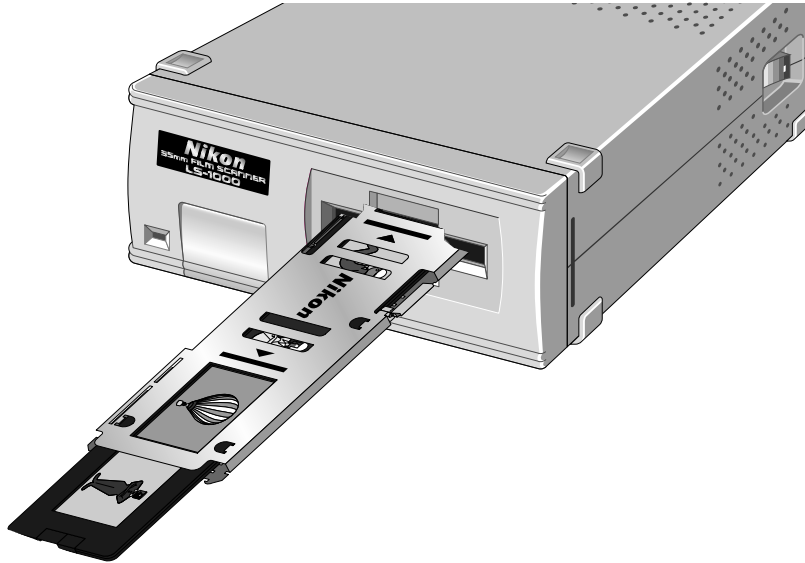

✓ Remarks:

- *Do not forcefully insert the film holder.*
- *Though the film holder is made of plastic, it will be damaged if film is forced into it.*
- *Remove dust on the film or film holder with a blower or photographic brush.*

6. Troubleshooting

If something unusual should occur, please check the following items before you assume that there is a unit failure. For more details, refer to the Troubleshooting section of the software manual.

Scanning cannot be performed.

- Is the SCSI cable connected?
Connect the SCSI cable.
- Are you using the supplied SCSI cable?
Use the supplied SCSI cable
- Is the end of the connected SCSI cable terminated?
Connect the terminator.
- Is the SCSI ID number different from the SCSI ID of other devices?
Change the ID number if it is duplicated.
- Are you using a recommended SCSI board ? (For Windows version)
Use a recommended SCSI board.
- Are the numbers you have set for I/O, INT and DMA for the SCSI board different from those for other boards? (For Windows version)
- Does your system satisfy our recommended system requirements?
Provide the recommended system.

- Have you installed software?
For information on installing and operating software, refer to the software manual provided with the unit.
- Have you properly set the configuration, such as CONFIG.SYS ?
If you have installed applications for Windows, for instance, note that the configuration may change automatically. (For Windows version)

Poor image quality.

- Have you set the film properly?
Set the film properly.
- Can you see dust on the film?
Remove dust on the film with a blower or photographic brush.
- Was the unit subjected to vibration during the scanning operation?
Place the unit where it will not be subjected to vibration or physical shocks.
- Are you using utility software properly?
For details, please refer to the manual for your software.

The auto slide feeder display LED does not light.

- Is the LS-1000 power on?
Turn on the power.
- Are the LS-1000 and the auto slide feeder properly connected?
Switch off the LS-1000 and re-connect.

Appendix: Specifications

Film used: 35mm film (color/monochrome, negative/positive)
Mounted slides (3.0mm or less and 1.1mm or more in thickness)
Strip film (up to 6 images)

Scanning method: Stepper-driven film stage, single pass method

Sensor: 2,592 pixel linear CCD image sensor

Light source: RGB LED Array

Color separation: RGB line sequential

Scanning area: 24.3 × 36.5mm, 2,592 × 3,888 pixels.
Strip film holder aperture is 23.4 × 35.4mm.

Scanning resolution:

Pixel size: 9.4 micron square pixel

Pixel density: 106 pixels/mm, 2,700 dpi (on film surface)

A/D conversion: 12 bits/color

Output data: Full color (8 bits/color)

Focus: Auto-focus

Film holder: Not required for mounted slide scanning.
FH-2 is used for strip film scanning.

Interface: SCSI-2 compliant

Size: 6.0 (W) × 10.5 (H) × 2.5 (D) inches
(151 × 267.5 × 63.3mm)

Weight: Approx. 4.2lbs (1.9kg)

Power supply: AC 100 - 120V/AC 200 - 240V, 50/60Hz,
0.80 - 0.4A

Temperature: 50°F – 95°F (10°C – 35°C)

Humidity: 20% – 85% (no condensation)

Options: Nikon Auto Slide Feeder SF-100



Index

A

AC inlet 16
Accessories 12

C

Connecting 19–25
 connecting the SCSI cable 21
 connecting the terminator 22
 preparation for 19
 to other devices in an SCSI chain 23

F

FH-2 12, 18
 adaptor snap 18
 holder snap 18

Film

 inserting 27–34
Film slot 15
Film strips
 inserting 29–34

I

Installation
 horizontal 11
 vertical 11

L

LED. *See* Status display LED

M

Main unit 15–16
Maintenance 14

O

Operating environment 11
Option connector 15

P

Power cord, connecting 20
Power switch 15

S

SCSI cable 12, 21, 22
SCSI connector 16
SCSI ID 25
SCSI ID switch 16
SF-100 auto slide feeder 13
Slides
 mounted, inserting 27–28
 orientation of landscape slides 28
 orientation of portrait slides 28
Specifications 34
Status display LED 15, 17
Strip film holder. *See* FH-2

T

Terminator 12, 22
Troubleshooting 33
Turning on 26

V

Ventilation holes 15



EC DECLARATION OF CONFORMITY

We
Name: Nikon UK Limited
Address: Nikon House, 380 Richmond Road, Kingston, Surrey KT2 5PR, UK

declare that the product
Product Name: Nikon 35mm Film Scanner LS-1000
Product Option: Auto Slide Feeder SF-100
Manufacturer's Name: Nikon Corporation
Manufacturer's Address: Fuji Bldg., 2-3, Marunouchi 3-chome, Chiyoda-ku, Tokyo 100, Japan

is in conformity with the following Standards
EN55022 Class B
EN50082-1
IEC801-2: 1991 4kV
IEC801-3: 1984 3V/m
IEC801-4: 1988 1kV AC, 0.5kV I/O

following the provisions of the EMC Directive (89/336/EEC)

DECLARATION DE CONFORMITE DE LA CEE

Nous
Nom: Nikon UK Limited
Adresse: Nikon House, 380 Richmond Road, Kingston, Surrey KT2 5PR, UK

déclarons que ce produit
Nom du produit: Nikon 35mm Film Scanner LS-1000
Option au produit: Passe-Vues Automatique SF-100
Nom du fabricant: Nikon Corporation
Adresse du fabricant: Fuji Bldg., 2-3, Marunouchi 3-chome, Chiyoda-ku, Tokyo 100, Japan

est conforme aux normes suivantes
EN55022 Classe B
EN50082-1
IEC801-2: 1991 4kV
IEC801-3: 1984 3V/m
IEC801-4: 1988 1kV AC, 0.5kV I/O

selon les dispositions de la directive de la CEE (89/336/EEC)

ERKLÄRUNG ÜBER EG-NORMENGERECHTHEIT

Wir
Name: Nikon UK Limited
Anschrift: Nikon House, 380 Richmond Road, Kingston, Surrey KT2 5PR, UK

erklären hiermit, daß das folgende Produkt
Produktbezeichnung: Nikon 35mm Filmscanner LS-1000
Produkt-Sonderzubehör: Automatische Diapositiv-Zufuhr SF-100
Name des Herstellers: Nikon Corporation
Anschrift des Herstellers: Fuji Bldg., 2-3, Marunouchi 3-chome, Chiyoda-ku, Tokyo 100, Japan

den nachstehend aufgeführten Normen genügt:
EN55022 Klasse B
EN50082-1
IEC801-2: 1991 4kV
IEC801-3: 1984 3V/m
IEC801-4: 1988 1kV AC, 0.5kV I/O

und zwar gemäß den Bestimmungen der EMC-Richtlinie (89/336/EEC)

Kingston, UK

September 30, 1995

Place
Lieu
Ort

Date
Date
Datum

Signature/Managing Director
Signature/Directeur général
Unterschrift/Geschäftsführer